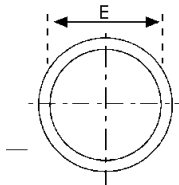
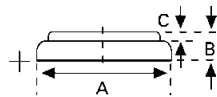

Data Sheet

Type Number	6216	
Designation IEC	CR 1216	
System	Li-Manganese dioxide / Organic Electrolyte	
UL Recognition	MH 13654 (N)	
Nominal Voltage	3 V	
Typical Capacity C	27 mAh	
Load 39 kOhm, at 20°C down to 2 V		
Weight (approx.)	0,7 g	
Volume	0,17 ccm	
Coding	Date of Manufacturing Month/Year	
Temperature Ranges	min	max.
Storage	-55°C	70°C
Discharge	-20°C	70°C
Dimensions	min	max.
Diameter (A)	12,2	12,5
Height (B)	1,4	1,6
Shoulder Diameter[E].....	10,0	
Shoulder Height [C].....	0,2	

Typical Capacities (at 20°C)

Discharge Type	Load	End Voltage:	2.0 V
Continuous 24h/d,7d/w Current [μ A]:	39000 Ω	Time: Capacity [mAh]: Energy [mWh]:	355 h 27 77

* Contact VARTA if the application is intended to be outside the range of -20°C to +70°C.

*Information and contents in this data sheet are for reference purpose only.
They do not constitute any warranty or representation and are subject to change without notice.
For most current information and further details, please contact your VARTA representative.*

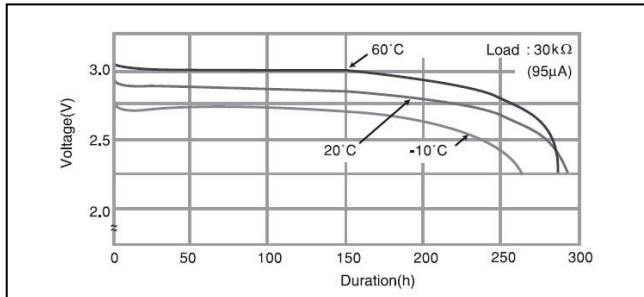
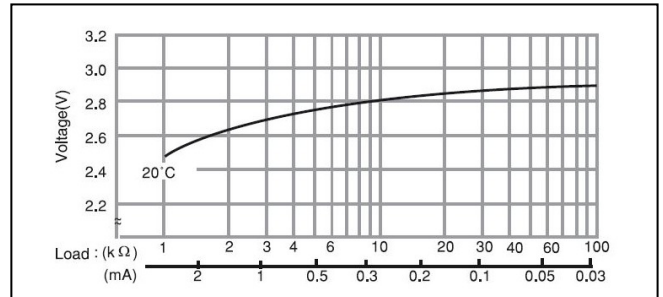
Data Sheet
Performance Data:
• Temperature Characteristics

• Operating Voltage vs. load resistance*

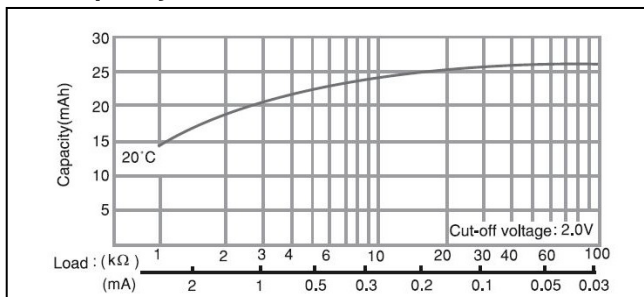
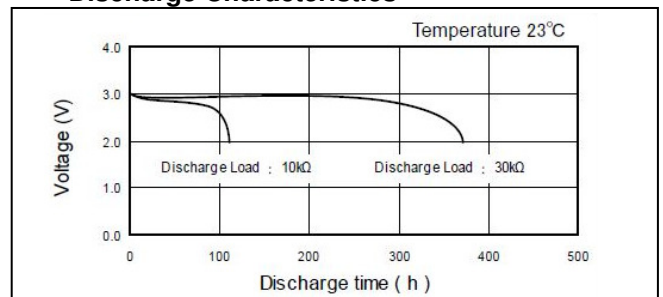
*Discharge depth 50%

• Capacity vs. load resistance

• Discharge Characteristics

- Self-discharge rate < 1% at room temperature
- Storage life > 10 years
- Operating life* > 10 years

* depending on environmental condition and energy consumption

*Information and contents in this data sheet are for reference purpose only.
They do not constitute any warranty or representation and are subject to change without notice.
For most current information and further details, please contact your VARTA representative.*